

Connect. Adjust. Save.

WI-FI USER GUIDE

CONTENTS

New account: activate and register products

New account.....	p. 3
------------------	------

Functional description for using the app

Main view.....	p. 6
Menu.....	p. 6
Account.....	p. 6
Zones.....	p. 7
Weekly program zones.....	p. 9
Product for main menu.....	p. 10
Product.....	p. 11
Weekly program.....	p. 12
Away mode.....	p. 13
Delete products.....	p. 14
Delete zones.....	p. 14

New account

Create an account

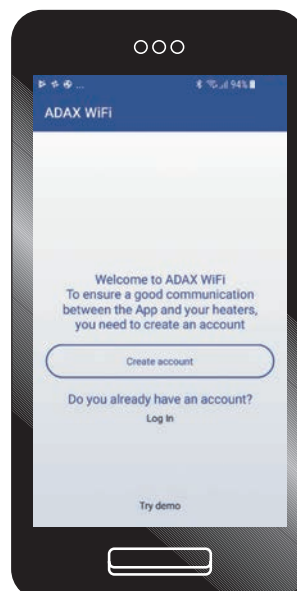
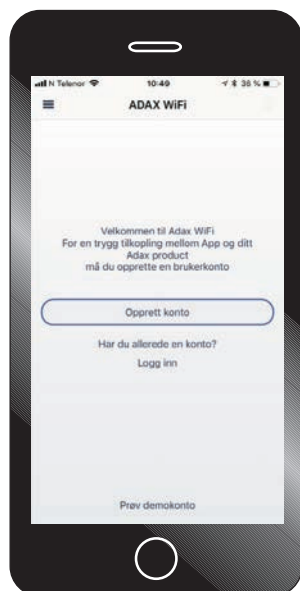

Create an account.
Use your email as your user name. Please read and agree the terms and conditions to open your account.

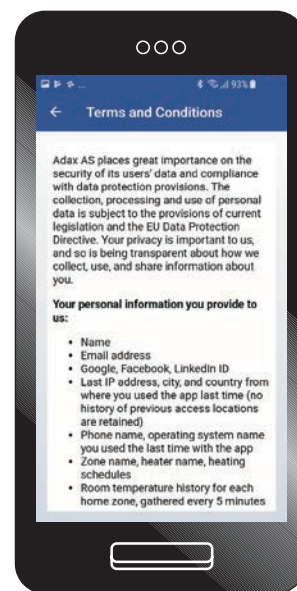
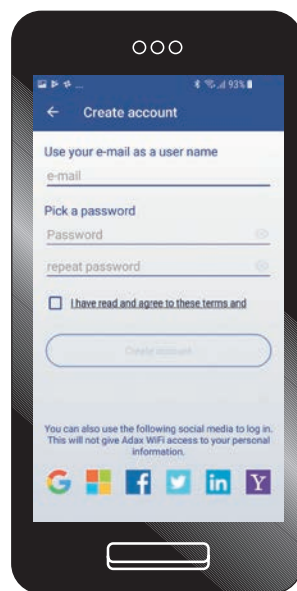
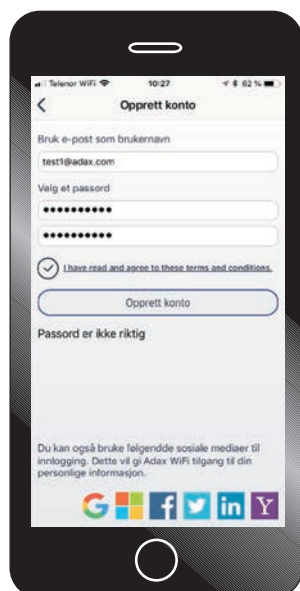

Your account is ready.
You can now add and register your Adax heaters and/or Smart Wi-Fi plugs.

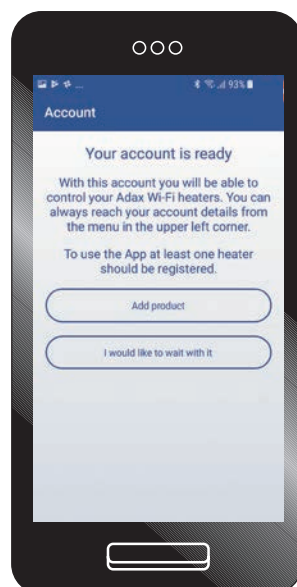

Register heater

Register your heater and/or Smart Wi-Fi Plug. Follow the instructions given.

Note!

Your phone/device must be connected to the internet, through a Wi-Fi connection on your 2,4 GHz band. SSID/Network name must be your 2,4 GHz band.

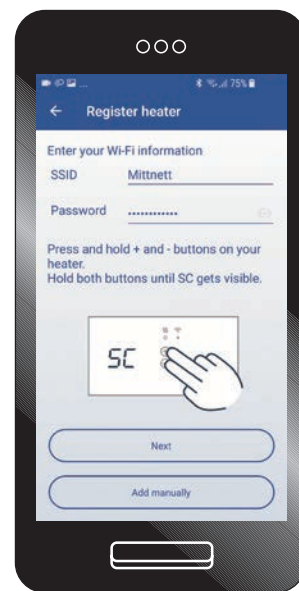
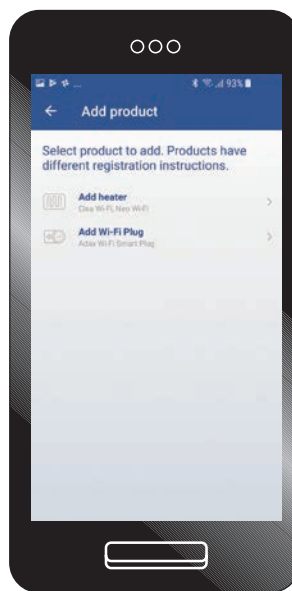
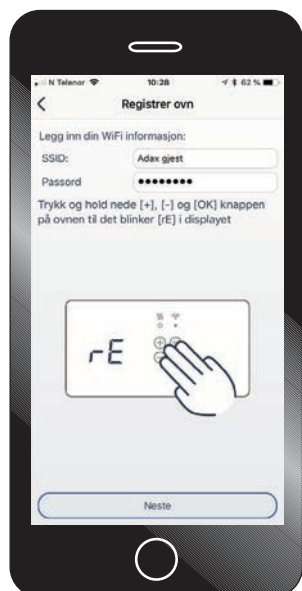

With the latest firmware the system should connect automatically.

With an older version of firmware you will need to manually connect to your heater. Please find instructions below.



For manual installation of your heater, you must log into the heaters network. The heaters SSID/network name is SH-ADAX-XXXXX and the password is "magicpass123".

If you cannot find the SH-ADAX-XXX on your list, it is recommended that you switch the Wi-Fi OFF and ON to refresh the list of available networks.

When the heater is connected - go back to the Adax Wi-Fi app to complete registration.

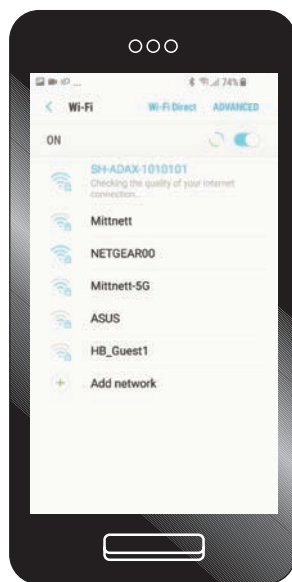

Register heater

The app is searching and registering your heater.

This process can take up to 20 seconds.

If the registration fails, and you are asked to try again, please check that network name/SSID and password is correct.

Remember that the SSID has to be your 2,4 GHz band.

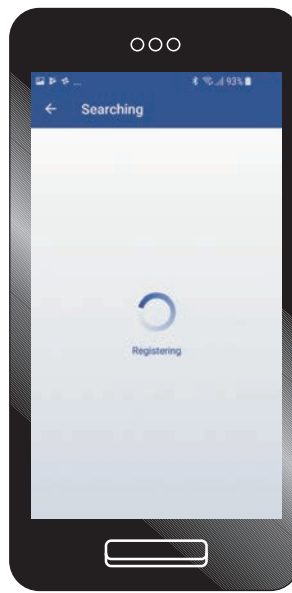
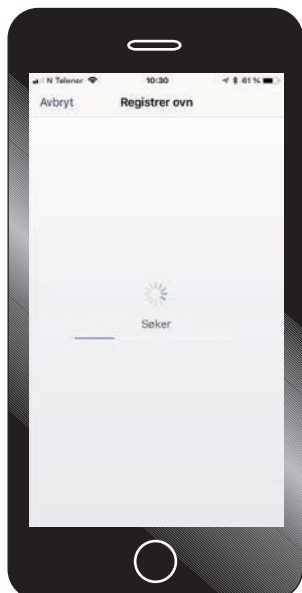

Your heater is now registered to the app. We recommend that you give the heater/product a name, ex. "Living room", "Kitchen" or "Office".

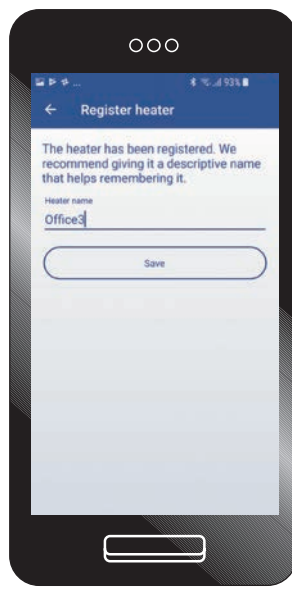
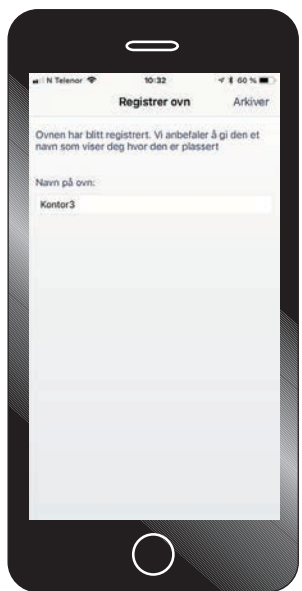

Only for Android:

Register your heater to a zone, name the zone where you place your heater. If you have several heaters linked to the same zone, you can control all heaters with the same setting and schedule.

Note!

For IOS the heater is connected to a Zone from Zone in main menu.

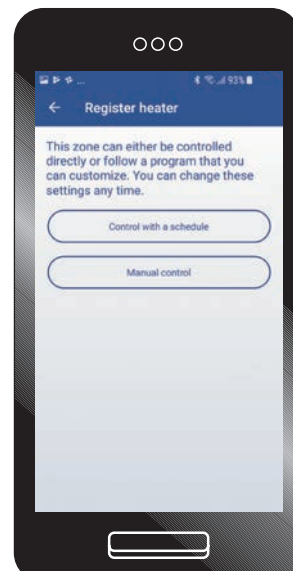
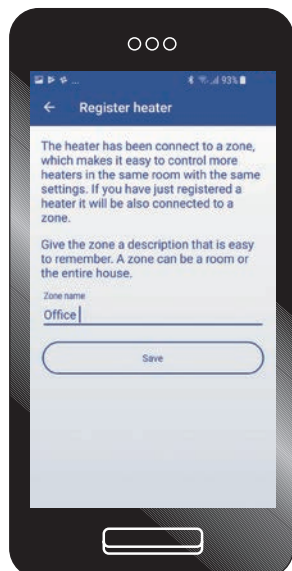

Main view

Settings of your heater/ zone. The numbers indicate (15/20°C), e.g. the temperature the heater is set to. Adjust up or down with "+" or "-". The number (23.2°C) is the actual "room" temperature. The three symbols below from the leftside: "Scheduling" - here you can set a "Week program". The "hand icon" in the middle is for manually control of the temperature.

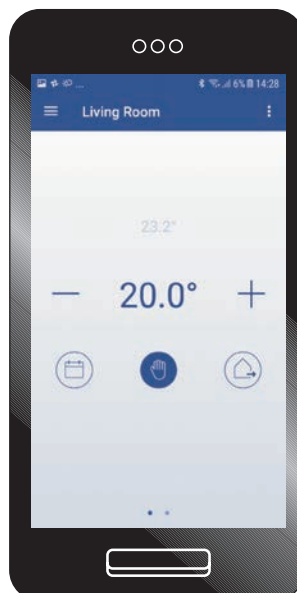
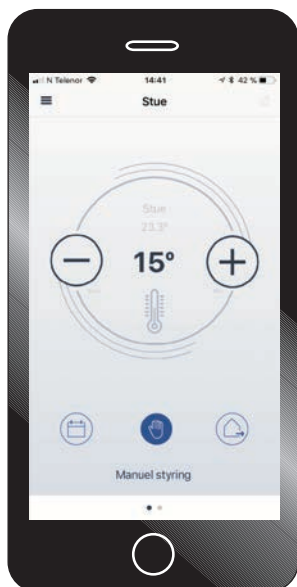

The last symbol is "Away" mode where you can set a fixed temperature if you leave your home for a longer periode or go on vacation etc.

If you have several heaters/zones installed to your Adax Wi-Fi App, you can change view between heaters/zones by swiping left or right in the window.

Menu

Main menu in the upper left corner gives you access to:

1. Account info
2. Zone settings
3. Device - Add and view details for your heaters and plugs.
4. Schedules - Add and edit weekly programs.

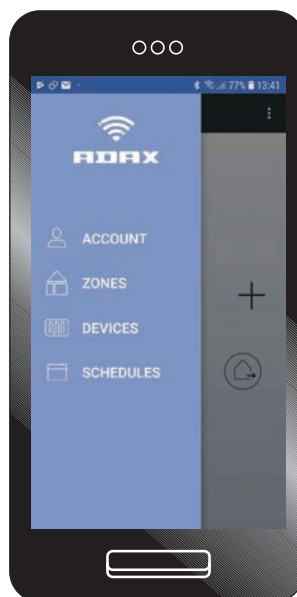

Account

Account: Account details, version number of app etc. Account ID is needed for support.

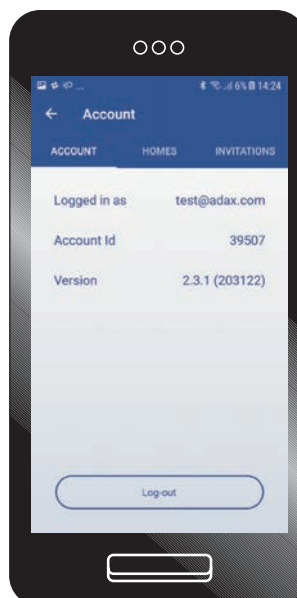

Zones

Add and manage your different zones.

The App can manage several homes/locations, like "House", "Cabin", or "Apartment".

In a "Home" you can add several zones like "Living room", "Kitchen" and/or "Bedroom".

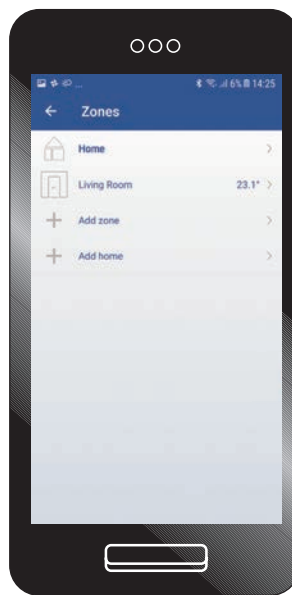
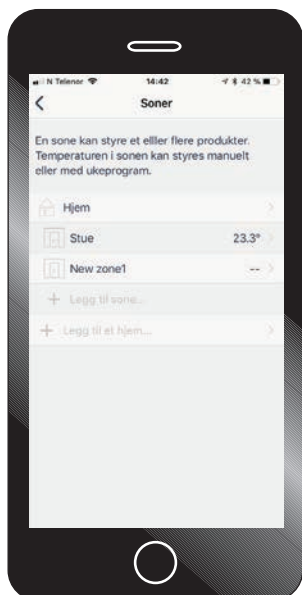

If you click on "Home" from main view in Zone, you can edit the name and invite other users to manage the settings of your heaters.

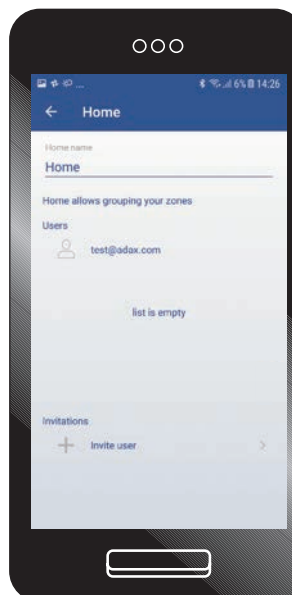
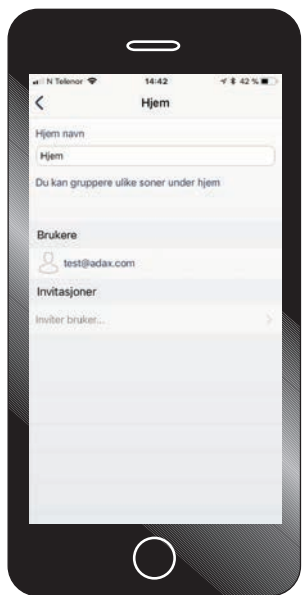

Zones

When you click on zone "Living room" you will find several settings and options. First you can edit and change the name of the zone.

Feature list:

Temperature monitoring, in "ON" mode it will send you push messages when the room temperature is changing.

"Child lock" - lock the options to manually change the temperature on the heaters thermostat.

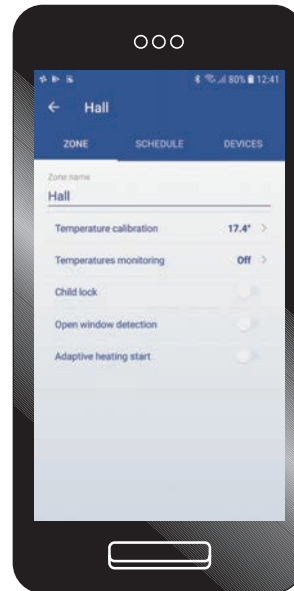
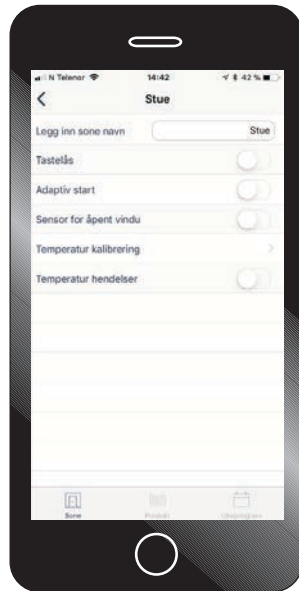

"Open window detection" - the heaters detects if the temperature quickly drops and will set the heating temperature to 7°C, when the room temperature stabilizes the heater will start to heat as normal.

"Adaptiv heating start"

When you set temperature to 22°C at 16:00 the heater will know when to start heat to reach 22°C at 16:00. In this view you can also go directly to "schedule" for this zone and "devices" linked to the actual zone.

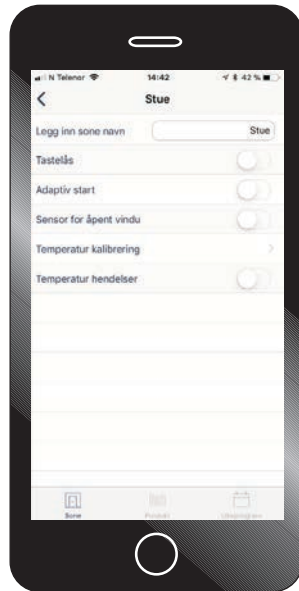

In this view "Device" you can add and manage devices/ heaters linked to a zone. Note that the devices has to be installed before you can manage devices.

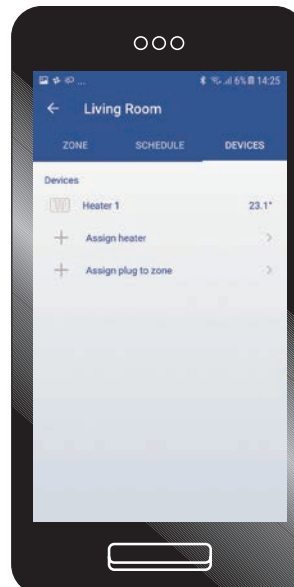
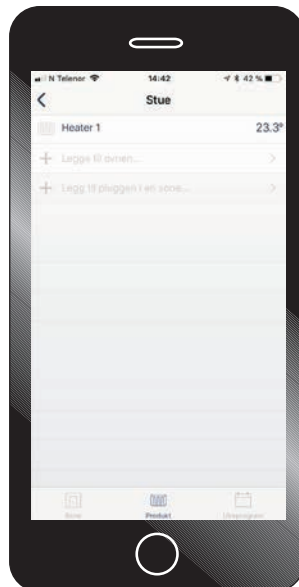

Week program for zones

In this view "scheduling" from zone you can edit and manage your weekly programs. Set individual temperature for comfort and reduced temperature in a zone.

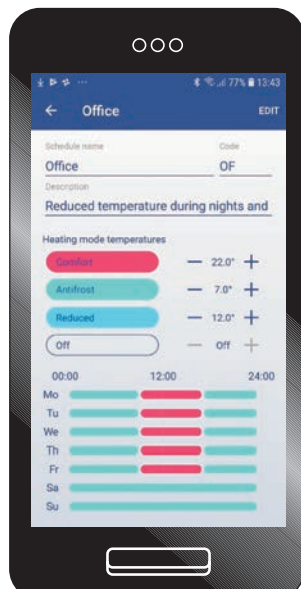
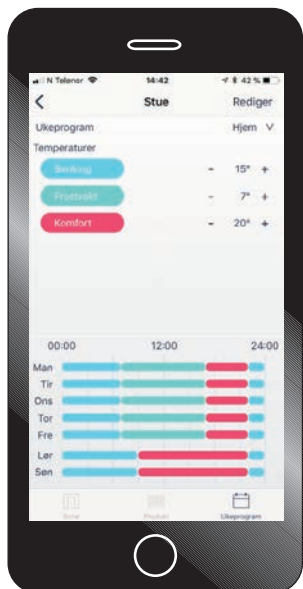

Edit and change week program.

- Set interval by choosing days.
- Set start and end time.
- Set heating mode - comfort or other preferred heating modes.

To set different heating modes during the day and week, you must repeat the process to cover the whole day.



Product from Mainmenu

Main menu - "Device" here you will find a list of all devices registered to the app by "Home" and "Zone". To add new heaters and other devices click on "Add products". To edit the name of the device, click on "Heater 1" to open and view.

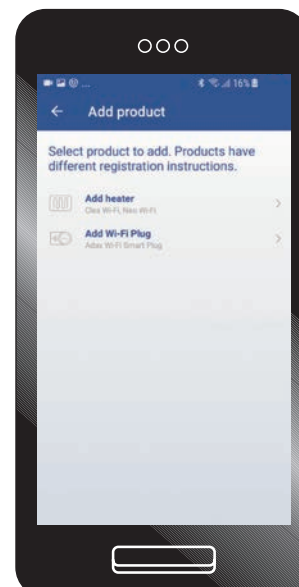
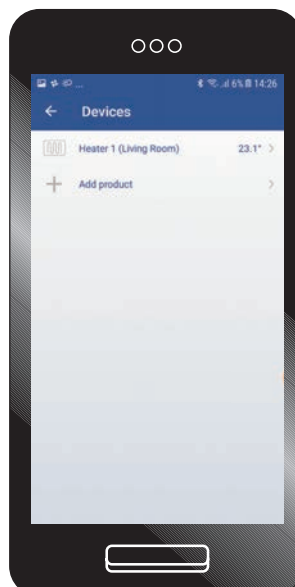
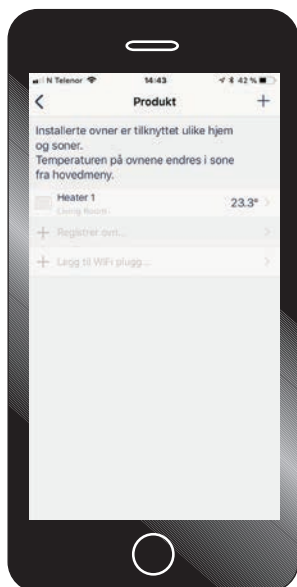

When you have clicked on the product, you will get detailed information of your heater, last recorded temperature, current temperature etc. If there is a new firmware available, you can update the firmware. Note that you can only update firmware when you are connected to the same network as the heater.

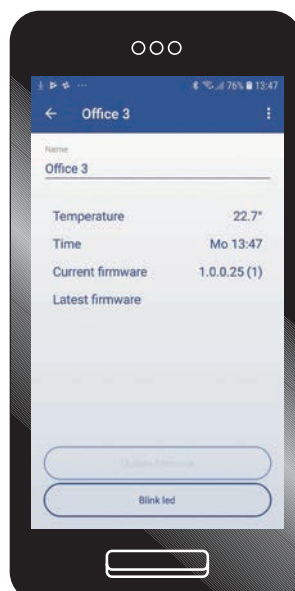
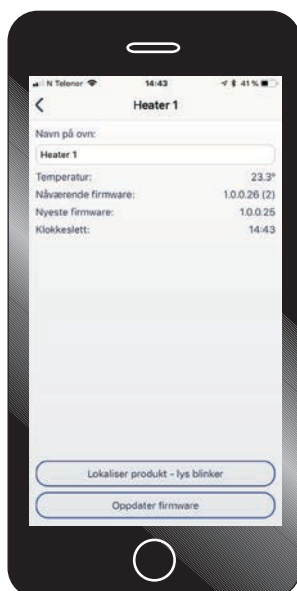

Product

If you have installed a Smart Wi-Fi plug you will find a second icon in your main view. Click on the "socket" to switch from heater to smart plug view. When you see your Smart Wi-Fi plug you can manually set ON/OFF or begin scheduling for the plug.

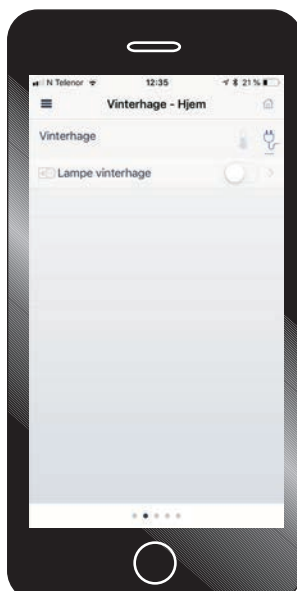

Product

In this view you set "Manual" or "Auto" control of your Smart Wi-Fi Plug. In "Auto" the plug works according to your schedule. The Schedule can be edited to your preference.

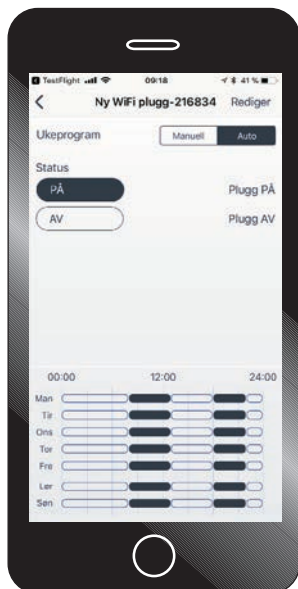

Edit and change week program for your Smart Wi-Fi Plug. Set day and time intervals with selected mode ON/OFF.

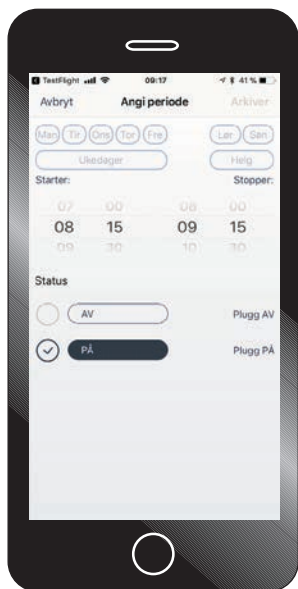

Week program

Main menu - "Schedules"
There are four predefined schedules/week programs to choose from. You can edit any of these programs to your preference or add and create a schedule from scratch with preferred time and heating modes.

Note!
This schedule only works for the heaters.
Smart Wi-Fi Plug scheduling is defined and managed in another view.

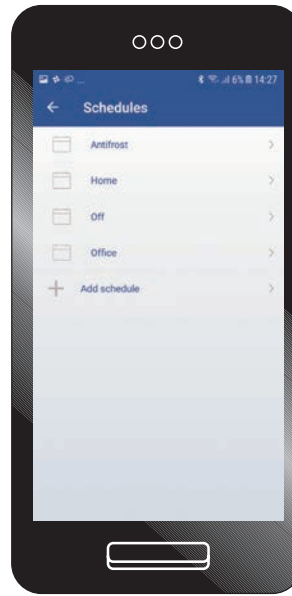
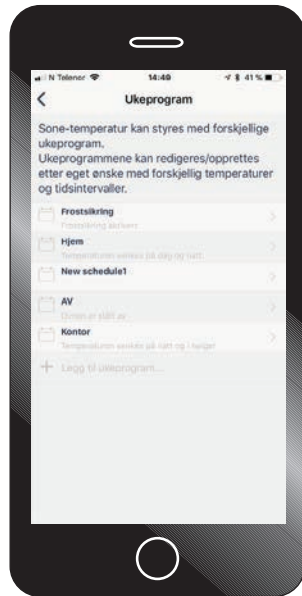

When choosing one of the weekly programs, you can view and see details for the program. Here you can edit and change the temperatures for different heating modes with "+" and "-". To edit days and time intervals choose "edit", in the upper right corner.

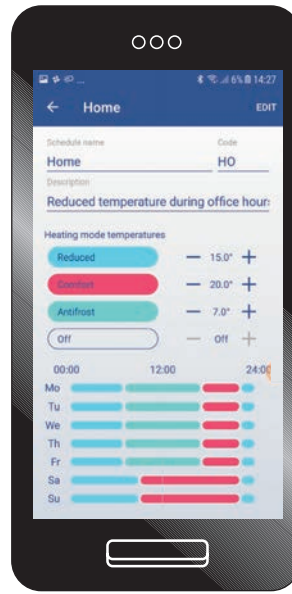

Edit and change week program.

- Set interval by choosing days
- Set start and end time
- Set heating mode - comfort or other preferred heating modes.

To set different heating modes during the day and week you must repeat the process to cover all 24 hours of the day.



Away mode

Main view - "Away" mode.

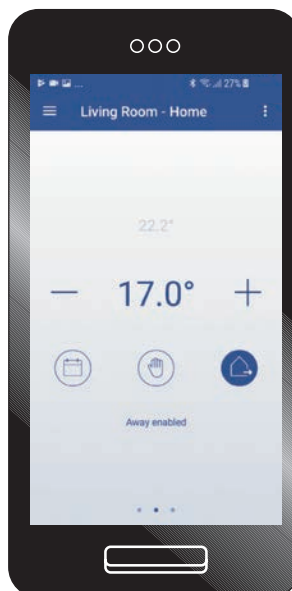

Away mode: Set "Away" mode temperature until you manually stop the settings.

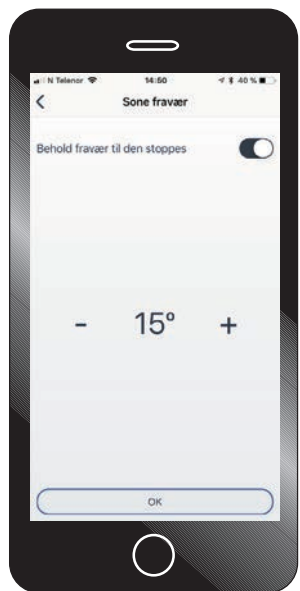

Manage temperature and date/time for when you would like the "Away" mode to be active.

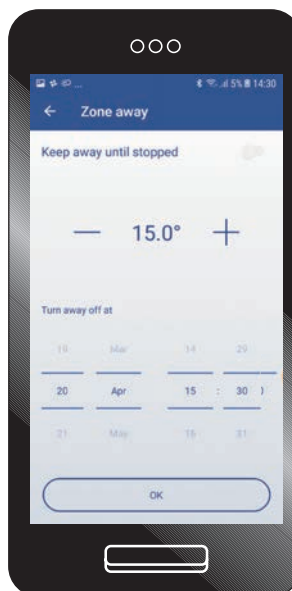
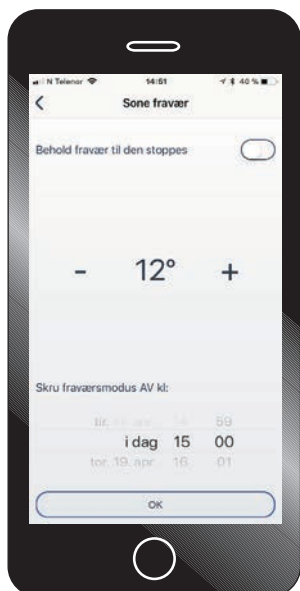

Delete products

Remove and delete products from your device list.

Swipe the product to your left and the "Delete" option will appear.

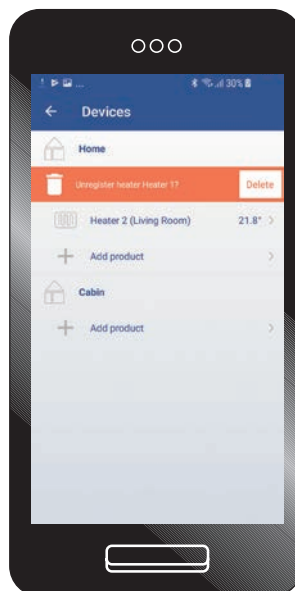
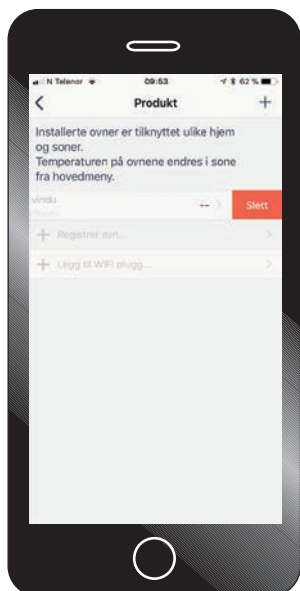

Delete zones

Remove and delete "Home" or "Room" from your zone list. Swipe the "zone" to your left and the "delete" option will appear.

